

輸送機零件組

Conveyor Parts Group

Contents 目錄

墊 片 CHAIN GUIDE PROFILES.....	1
平行墊片 CHAIN GUIDE PROFILES	2
護 欄 GUIDE RAILS	3 ~ 4
護 欄 夾 GUIDE RAILS CLAMPS	5 ~ 6
護欄支架 SIDE GUIDE BRACKETS.....	7 ~ 8
聯 接 架 / 支撐元件 CONNECTING CLAMPS / FRAME SUPPORT ELEMENTS	9 ~ 10
腳架元件 / 腳 蹄 SUPPORT BASES / ARTICULATED FEET.....	11~13
迴 路 輪 ROLLER GUIDES FOR CHAIN RETURN.....	14
門 樞 鈕 DOOR HINGE	15
萬向把手 / 大小把手 ADJUSTABLE HAND LEVERS / HANDLES.....	16
白鐵固定架 / 其他元件 STAINLESS STEEL SUPPORT / OTHER ELEMENTS	17
網 帶 MAT TOP CHAIN	18
齒輪/惰輪 SPROCKET / IDLER	19

CHAIN GUIDE PROFILES 墊片

Chain guide profiles 鏈條引導墊片

Material/材質

Polyethylene UPE with molecular density 183,000 Uhmwpe

UPE 材質含分子量密度 183,000

- Characteristics/特性
- Very low friction Coefficient
- High resistance to chemical agents
- No liquid absorption
- 超低摩擦係數
- 高酸鹼抗度
- 不吸水或其他液體

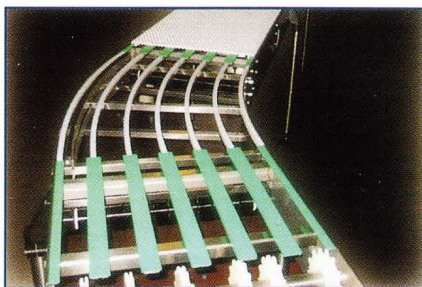
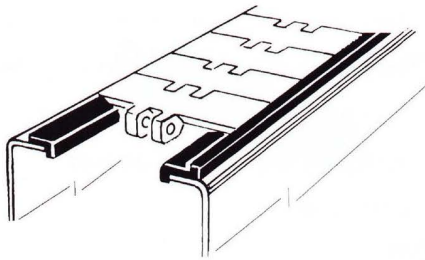
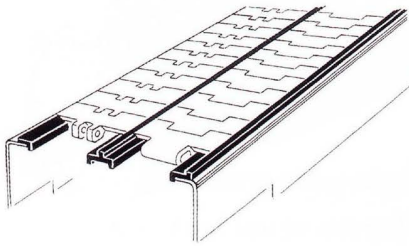

■ GP 244 Profile
平型墊片

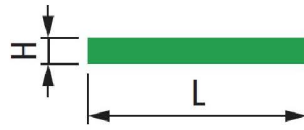

Dimension (吋吋)

L X H

20 x 3 (mm) 60M/捲-黑色

40 x 3 (mm) 60M/捲

20 x 5 (mm) 80M/捲

■ GP 243 L Profile 90M/Roll
型墊片 90M/捲

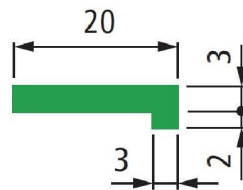

■ GP 241 Z Profile 80M/Roll
型墊片 80M/捲

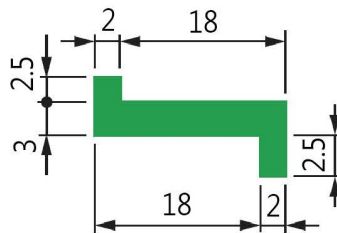

■ GP 242 T Profile 80M/Roll
型墊片 80M/捲

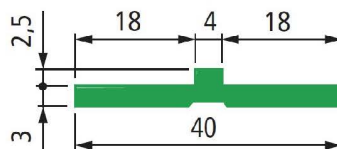

■ GP 362 □ Profile 6M/PCS
型墊片 6M/支

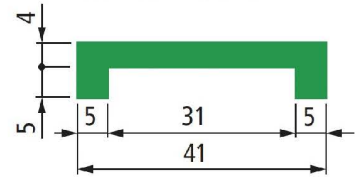

■ GP 262 大Z Profile 45M/Roll
型墊片 45M/捲

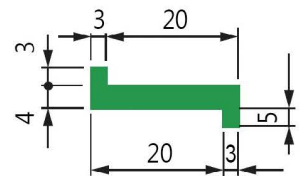

■ GP 261 LK Profile 40M/Roll
型墊片 40M/捲

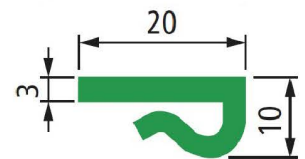

■ GP 251 ZK Profile 40M/Roll
型墊片 40M/捲

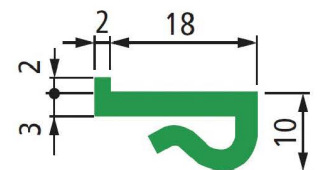

CHAIN GUIDE PROFILES 平行墊片

■ 平型墊軌



■ MIT-367 (19063VC) 3M,6M

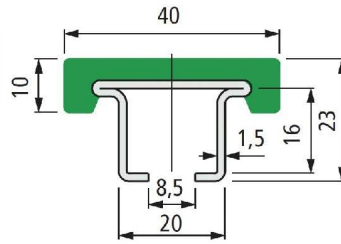

Material:

- Plastic profile in UPE metal profile in AISI 304.

材質：

- 塑膠部份為UPE材質，金屬部份為304不鏽鋼

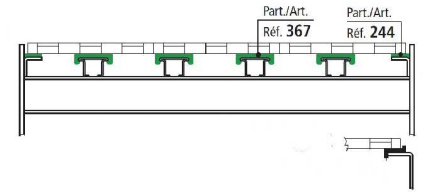
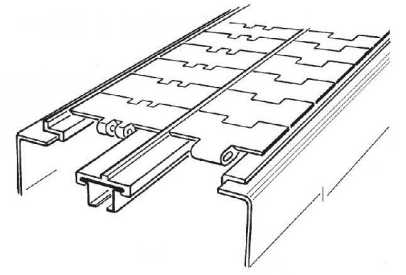

■ 螺絲固定座-單孔



■ MIT-14109

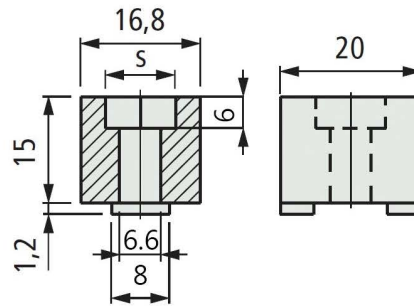

Material:

- Nylon
- Fixing with M8 hexagonal head bolt.

材質：

- 尼龍
- 固定M8六角螺絲

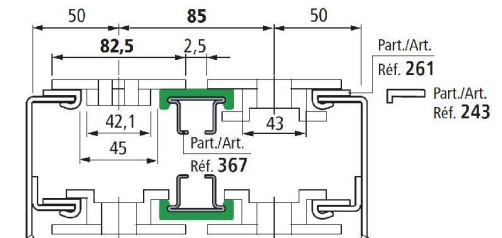

■ 螺絲固定座-雙孔

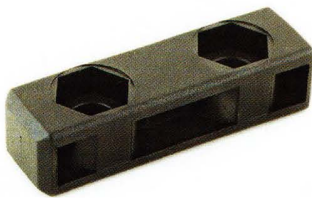

■ MIT-14111

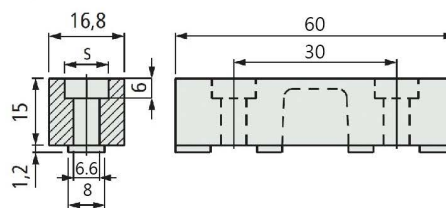

Material:

- Nylon
- Fixing with M8 hexagonal head bolt.

材質：

- 尼龍
- 固定M8六角螺絲

Chain guide profiles:

- Very low friction coefficient.
- High resistance to chemical agents.
- No liquid absorption.
- Quick assembly; easy to install.
- The plastic profile can slide along the metal profile, thus the heat makes expansion and the cold causes contraction.

特性：

- 超低摩擦係數
- 高酸鹼抗度
- 不吸水或其他液體
- 容易安裝
- 墊片延著機架延伸，因此吸收了熱脹冷縮的差異

■ 大C加鋁軌

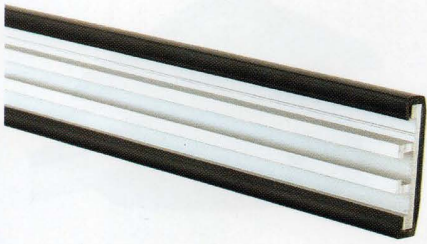

■ 圓帽護欄

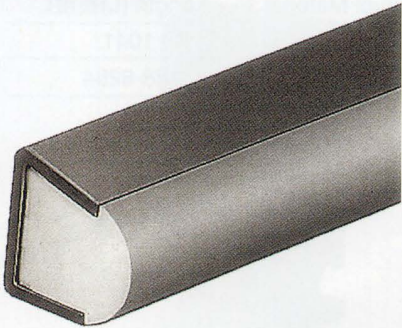

■ 鴨舌頭



■ 鋁毛刷-方型/圓型

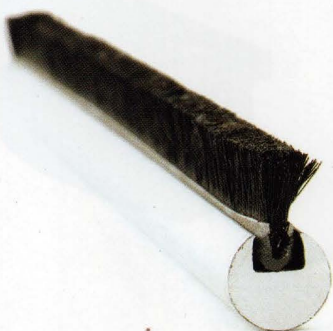

■ MIT-GL001 Aluminum guide+C profile (3M/支)

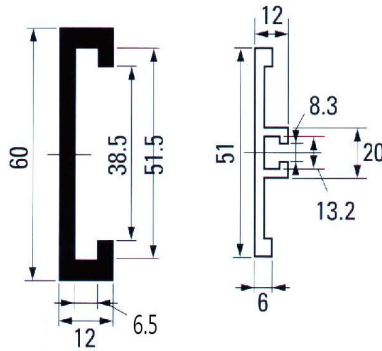

■ 219-61753 Round guide rail (3M/支)

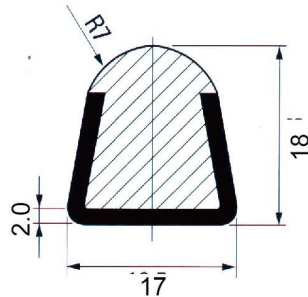

■ MIT-14110

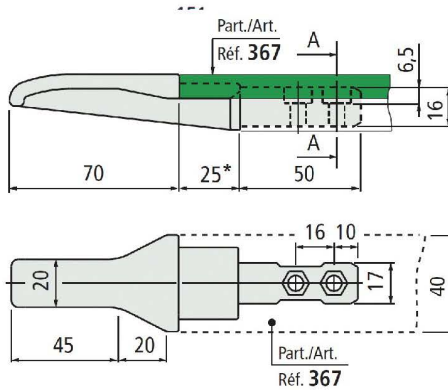

■ MIT-BRUSH-2M, 3M

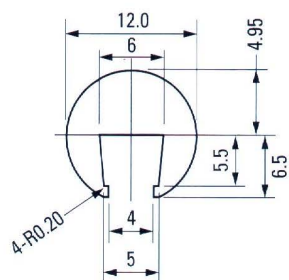

Material:

- Guide in aluminum, C profile in UPE

材質:

- 鋁軌為經陽極處理之鋁材，大C為UPE

Material:

- Plastic profile in PE, metal profile in AISI 304
- Min. Curvature radius: 145mm
- Weight: 0.54kg/m

材質:

- 支塑膠部份為PE材質，金屬部份為304不鏽鋼
- 最小彎曲半徑：145mm
- 重量：0.54公斤/米

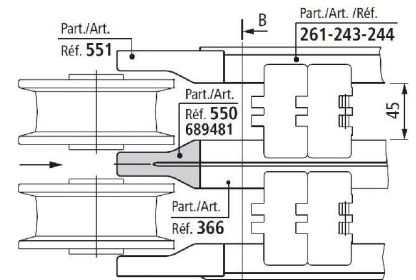

GUIDE RAILS 護欄

材質：

- 不鏽鋼型：螺絲為AISI 304，滾子桿為AISI 430F
- 鐵鍍新型：螺絲與滾子桿為鐵鍍鋅材質
- 滾子為POM材質
- 側邊塑膠部份為加強Polyamide PA

■ 單排算盤子護欄



■ 雙排算盤子護欄



■ 參排算盤子護欄



Guide rail for accumulation
算盤子護欄

Material:

- Version with stainless steel profile: screws in stainless steel AISI 304, roller pins in stainless steel AISI 430F.
- Version with zinc plated steel profile screws & roller pins in zinc plated steel.
- Roller in acetal POM.
- Side straps reinforced polyamide PA.

■ 128-62640 Guide rail for accumulation

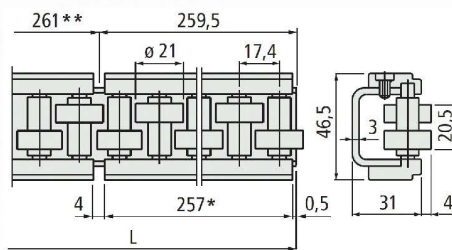

■ 128-62650 Guide rail for accumulation

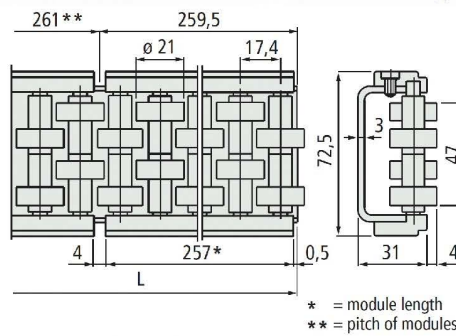

■ 128-62660 Guide rail for accumulation

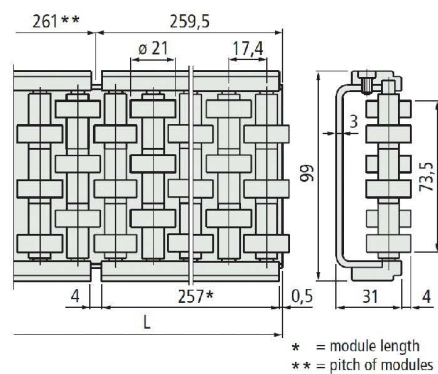

Product Material	Length (L)長度L
產品材質	1041
AISI 304不鏽鋼	128-6264

Product Material	Length (L)長度L
產品材質	1041
AISI 304不鏽鋼	128-6265

Product Material	Length (L)長度L
產品材質	1041
AISI 304不鏽鋼	128-6266

■ 圓單軌夾



■ 圓雙軌夾



■ 圓單軌接頭

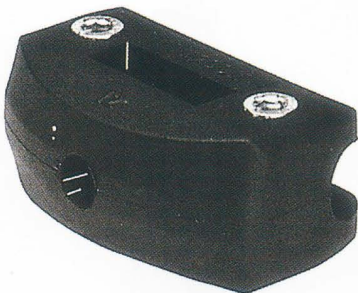

■ 方單軌接頭



■ MIT-CL006 single guide rail clamp

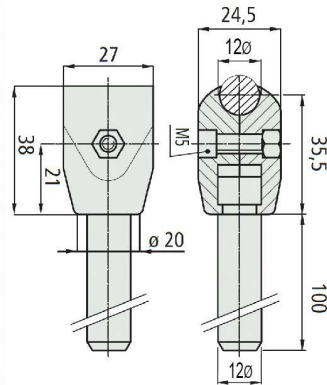

■ MIT-CL770 Double guide rail clamp

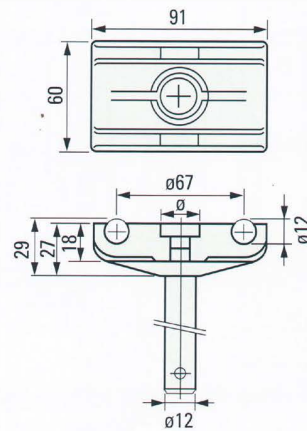

■ MIT-CL159 Adjustable guide rail clamp

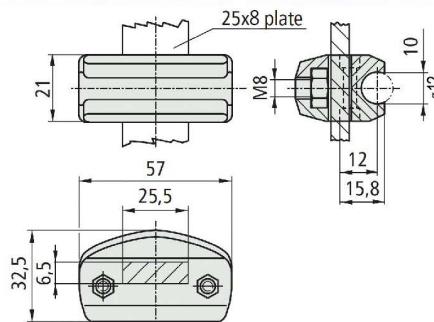

■ A222-001 Adjustable guide rail clamp

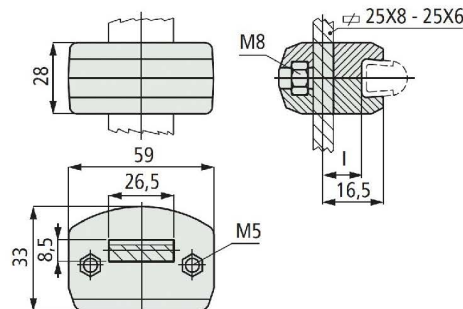

Material:

- Clamp in nylon.
- Pin in stainless steel AISI 304.

材質：

- 圓單軌夾為尼龍材質pin為304不鏽鋼

Material:

- Clamp in nylon.
- Pin in stainless steel AISI 304.

材質：

- 圓雙軌夾為尼龍材質pin為304不鏽鋼

Material:

- Clamp in nylon.
- Pin in stainless steel AISI 304.

材質：

- 圓單軌接頭為尼龍材質
- 螺絲/螺帽為304不鏽鋼

Material:

- Clamp reinforced in nylon.
- Bolt in AISI 304.
- Nut in nickel plated brass.

材質：

- 方單軌接頭為尼龍
- 螺絲/螺帽為304不鏽鋼

■ 方單軌夾



■ A222-002 Single guide rail clamp

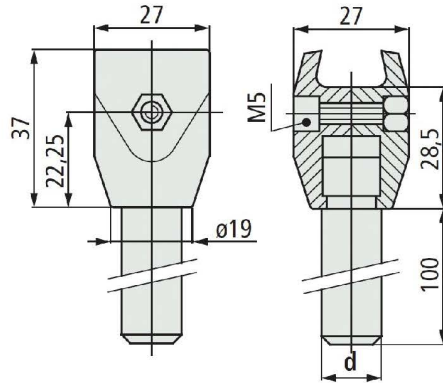

Material:

- Clamp in nylon.
- Pin in stainless steel AISI 304.
- Bolt in AISI 304.
- Nut in nickel plated brass.

材質：

- 方單軌夾為尼龍
- pin/螺釘/螺帽為304不鏽鋼

■ 方雙軌夾



■ MIT-CL213 Double guide rail clamp

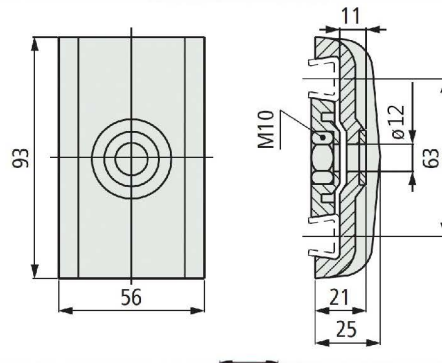

Material:

- Clamp in nylon;
- pin, bolt, washer & nuts in stainless steel AISI 304.

材質：

- 方雙軌夾為尼龍材質，pin
- 螺釘、華司與螺帽為304不鏽鋼

■ 導條夾頭

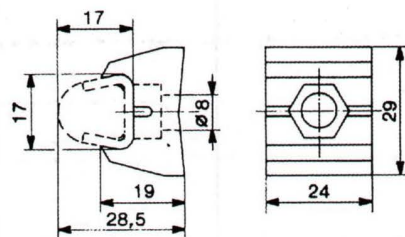

材質：

- Clamp in nylon.

材質：

- 導條夾頭為尼龍纖維

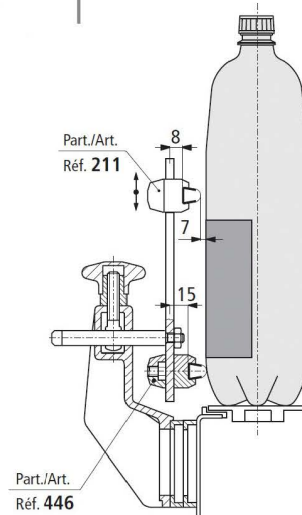
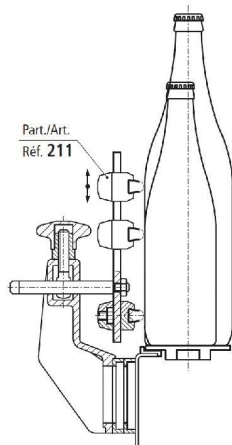

SIDE GUIDE BRACKETS 護欄支架

■ 小型支架



■ 中型支架



■ 大型支架



■ 調整型支架



■ MIT-SB692 Small side guide bracket

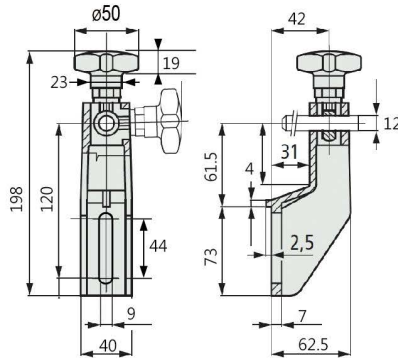

■ MIT-SB639 Middle side guide bracket

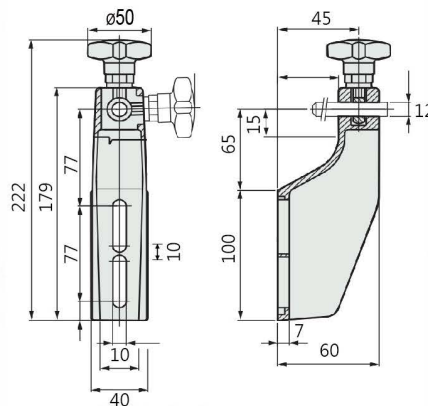

■ MIT-SB332 Large side guide bracket

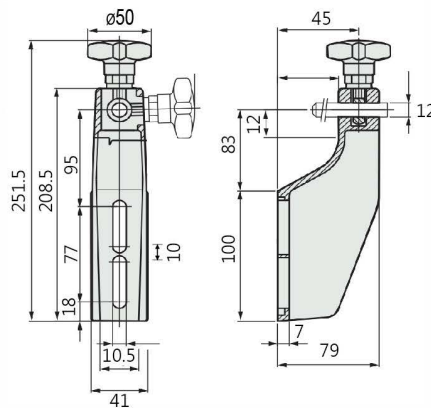

■ MIT-SB021 Adjustable bracket

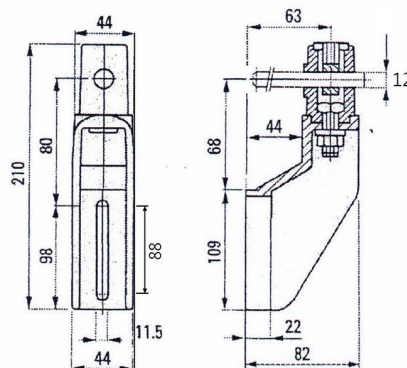

Material:

- Bracket & knob in nylon.
- Eyebolt in nickel plated brass.

材質：

- 支架及支架頭為尼龍材質，
- 單眼螺絲為304不鏽鋼

Material:

- Bracket & knob in nylon.
- Eyebolt in nickel plated brass.

材質：

- 支架及支架頭為尼龍材質，
- 單眼螺絲為304不鏽鋼

Material:

- Bracket & knob in nylon.
- Eyebolt in nickel plated brass.

材質：

- 支架及支架頭為尼龍材質，
- 單眼螺絲為304不鏽鋼

Material:

- Bracket in nylon.

材質：

- 支架為尼龍材質，

ADJUSTABLE BRACKETS 調整型護欄支架

■ 調整型支架



■ 白鐵旋轉頭



■ MIT-SB022 Adjustable bracket

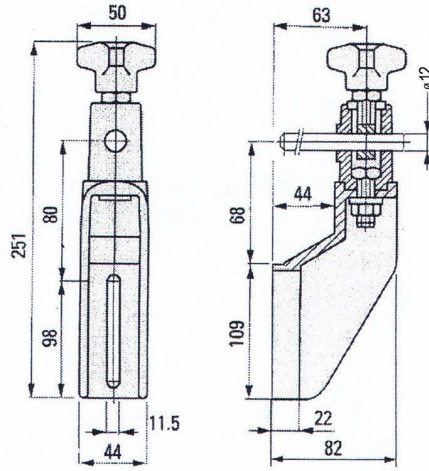

■ MIT-30mm

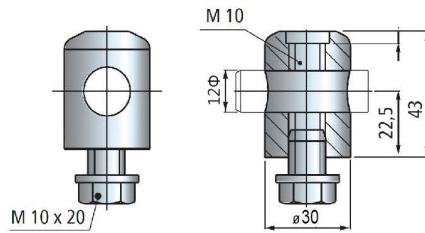

Material:

- Bracket & knob in nylon.
- Eyebolt in nickel plated brass.

材質：

- 支架及旋轉頭為尼龍材質，
- 單眼螺絲為為304不鏽鋼

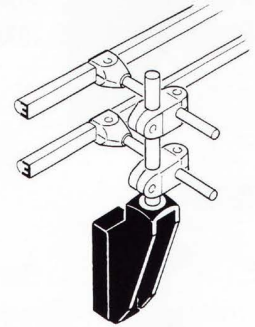

Material:

- AISI 304.

材質：

- 304不鏽鋼

※其他規格可再訂做

■ 支架頭外牙—白鐵 (S/S)

M10 L:15



■ 支架頭外牙—銅 (COPPER)

M8 L:18



CONNECTING CLAMPS 聯接夾

■ T型夾



■ MIT-CC339 T Clamp

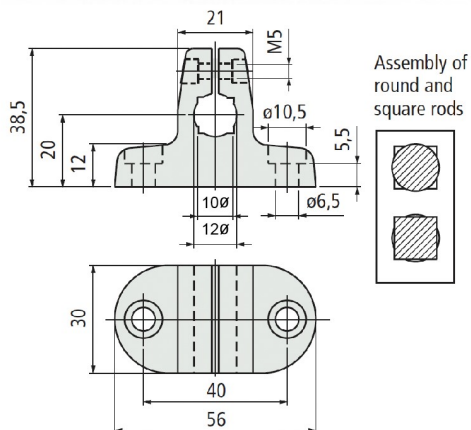

■ 十字型夾



■ MIT-CC340 T Clamp

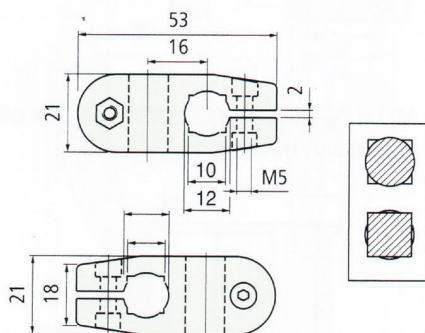

■ 感應器夾(測試器夾)



■ 341-68395 T Clamp for reflectors

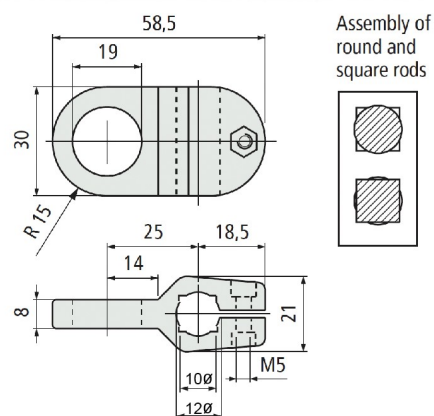

Part. No. 編號	Product name 產品名稱	Rod Squ ϕ mm□mm
CC339	T型夾	Rod 12 ϕ Squ10
CC339B	T型夾	Rod 10 ϕ Squ8

Material:

- Nylon. Weight:0.03kg
- Max recommended tightening torque: 0.5kgm

材質：

- T型夾為尼龍材質，
- 重量：0.03公斤
- 建議最大扭力：0.5公斤

Part. No. 編號	Product name 產品名稱	Rod Squ ϕ mm□mm
CC340	十字型夾	Rod 12 ϕ Squ10
CC340B	十字型夾	Rod 10 ϕ Squ8

Material:

- Nylon.
- Max recommended tightening torque: 0.5kgm

材質：

- 十字型夾為尼龍材質，
- 建議最大扭力：0.5公斤

Material:

- Nylon.
- Max recommended tightening torque: 0.5kgm

材質：

- 感應器夾為尼龍材質，
- 建議最大扭力：0.5公斤

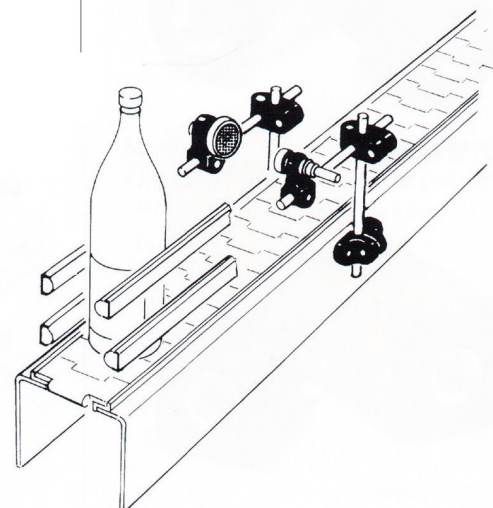
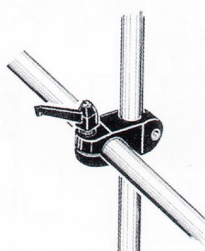
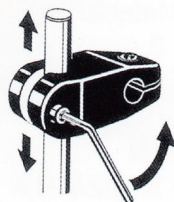

■ 支撐架(小)



■ 支撐架



■ 襯套 $\phi 48.3 / \phi 50$



■ 圓管腳套



■ 方管腳套

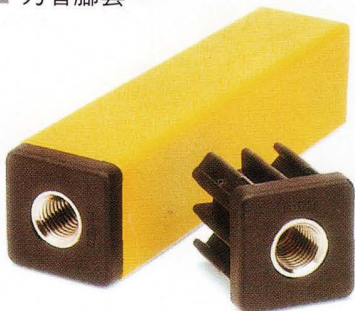

■ MIT-FS739 Frame Support

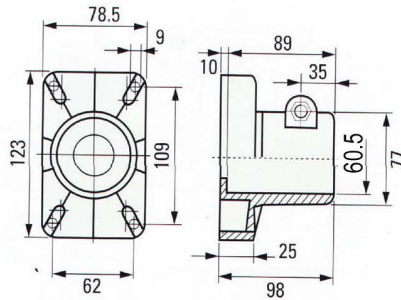

■ MIT-FS740 Frame Support

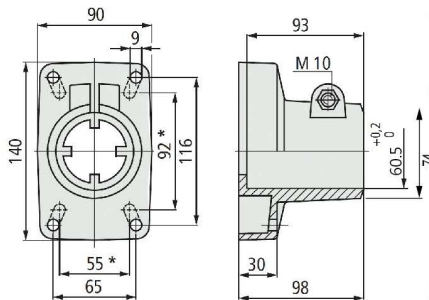

■ MIT-124-6197 $\phi 48.3$ / MIT-152404 $\phi 50$
Reduction bushing

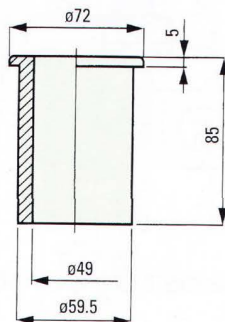

■ MIT-FS324 Threaded bushings for round tubes

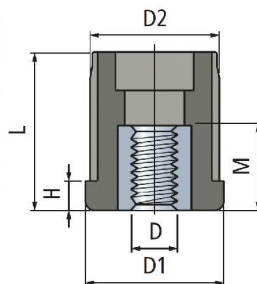

■ MIT-FS224 Threaded bushings for square tubes

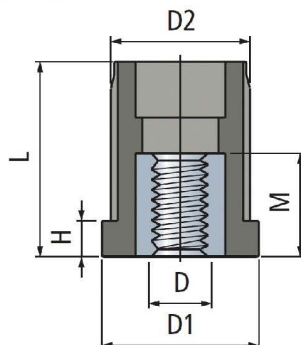

Material:

- Nylon, screws in stainless steel.

材質：

- 支撐架為尼龍材質，螺絲為不鏽鋼材質

Material:

- Nylon, screws in stainless steel.

材質：

- 支撐架為尼龍材質，螺絲為不鏽鋼材質

Material:

- Nylon.

材質：

- 尼龍材質

規格	D	D ₁	D ₂	M	H	L
$\phi 38$	M12/M16/M20	38	34.5	30	7.8	42.7
$\phi 50$	M12/M16/M20	49.6	47.9	30	9.7	48.7
$\phi 60$	M12/M16/M20	59.7	56.4	30	9.9	55

Material:

- Bushing in nylon threaded insert in nickel plated brass.

材質：

- 尼龍材質，填入螺母為銅鍍鎳

規格	D	D ₁	D ₂	M	H	L
$\phi 38$	M12/M16/M20	38.2	35.5	30	7.9	43.2
$\phi 50$	M12/M16/M20	50.1	48	30	9.8	55

Material:

- Bushing in nylon threaded insert in nickel plated brass.

材質：

- 尼龍材質，填入螺母為銅鍍鎳

■ 聯合架 (ø60.3)



■ A989-001 Connecting joint

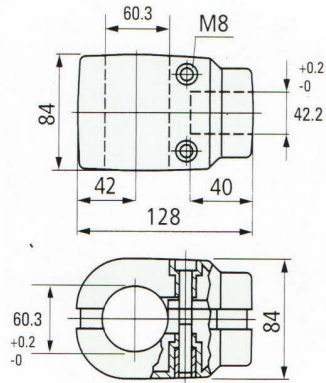

Material:

- Joint in Nylon.
- Tightening screws in stainless steel AISI 304, threaded bushing in nickel plated brass.

材質：

- 聯合架為尼龍
- 螺絲為不鏽鋼，螺紋襯套為銅鍍鎳
- 重量：0.44公斤
- 建議最大扭力：1公斤

■ 側邊鎖頭 (ø48.3/ø50.8/ø60.3)



■ 14740-ø48.3 14744-ø50.8 14745-ø60.3 Side mounting top bracket

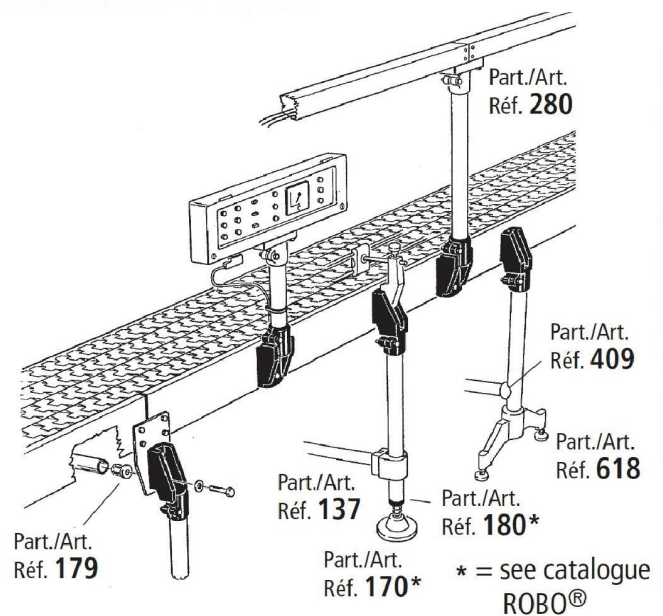
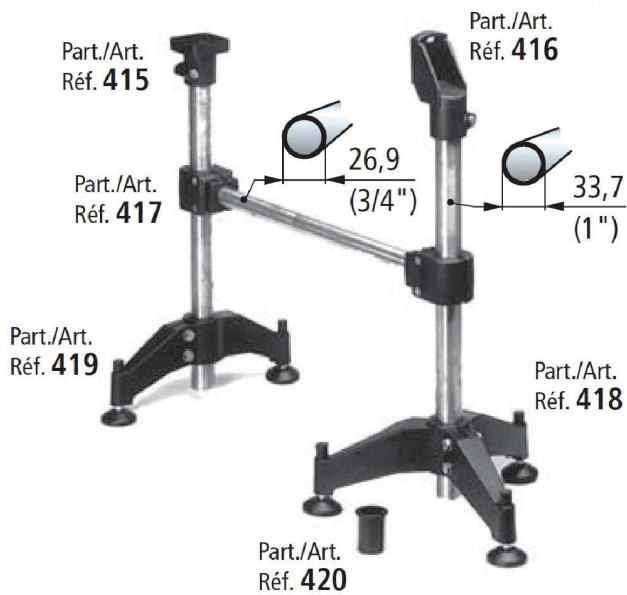
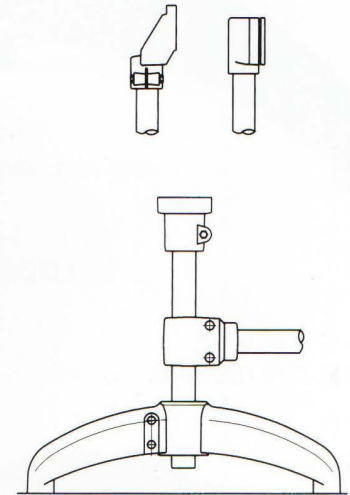
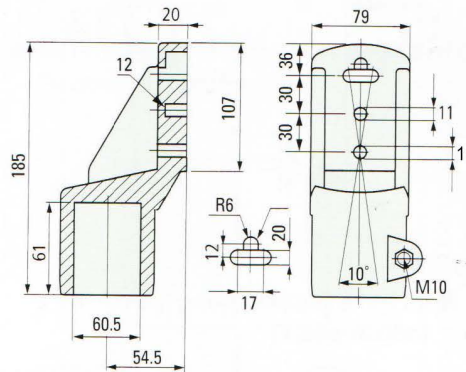

■ 三爪腳架



■ MIT-615 Support Base (tripod)($\phi 60.3$)

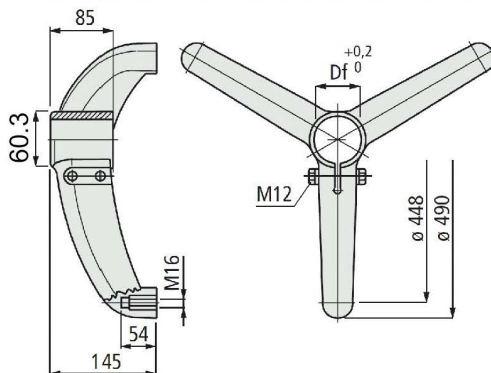

Material:

• Support base in nylon,(black) brass threaded bushings.

- Weight: 1.45 kg
- Max recommended tightening torque 3.6 kg/m.

材質：

• 尼龍材質

■ 二爪腳架



■ MIT-618 Support Base (bipod)($\phi 60.3$)

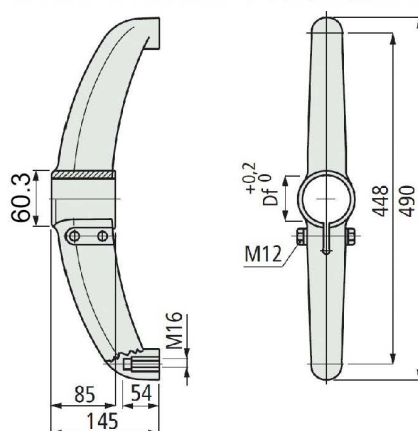

Material:

• Support base in nylon,(black) brass threaded bushings.

- Weight: 1.05 kg
- Max recommended tightening torque 3.6 kg/m.

材質：

• 尼龍材質

■ 二爪半180°腳架



■ MIT-619 Support Base (bipod 180°)($\phi 60.3 \sim \phi 42.7$)

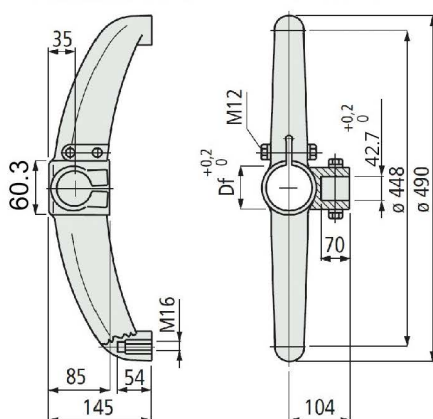

Material:

• Support base in nylon,(black) brass threaded bushings.

- Weight: 1.05 kg
- Max recommended tightening torque 3.6 kg/m.

材質：

• 尼龍材質

■ 二爪半120°腳架



■ 616-624552 Support Base (bipod 120°)($\phi 60.3 \sim \phi 42.7$)

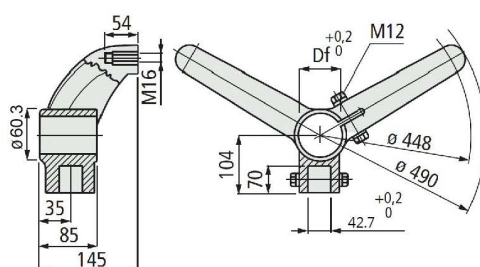

Material:

• Support base in reinforced polyamide PA FV (black) brass threaded bushings.

- Weight: 1.05 kg
- Max recommended tightening torque 3.6 kg/m.

材質：

• 加強尼龍材質

■ 固定腳蹄/
MIT-FT Fixed feet



■ 尼龍關節腳蹄/
MIT-FT Articulated feet



■ 全白鐵關節腳蹄/
MIT-FT 16SS Articulated feet



■ 半月型腳蹄
M1T-FT16.150.D
M1T-FT16.180.D



Material:

- Basement in nylon, threaded spindle in stainless steel AISI 304, and antivibration version with rubber hardness 70 shore.

材質:

- 腳蹄座為尼龍材質，螺絲軸心全為304不鏽鋼材質，防震橡膠墊為硬度70之橡膠

規 格	L(總長)	L2(牙長)	底 盤
M16	105	50	ø100
	154	100	ø100
M20	105	50	ø100 ø125
M24	154	100	ø100 ø125
	195	150	ø100 ø125

Material:

- Basement in nylon, threaded spindle in stainless steel AISI 304, and antivibration version with rubber hardness 70 shore.

材質:

- 腳蹄座為尼龍材質，螺絲軸心全為304不鏽鋼材質，防震橡膠墊為硬度70之橡膠

規 格	L(總長)	L2(牙長)	底 盤
M12	105	60.100.150	ø60 ø80 ø110
M16	154	50.100.150	ø60 ø80 ø110
M20	195	50.100.150	ø60 ø80 ø110

Material:

- Basement in nylon, threaded spindle in stainless steel AISI 304, and antivibration version with rubber hardness 70 shore.

材質:

- 腳蹄座為尼龍材質，螺絲軸心全為304不鏽鋼材質，防震橡膠墊為硬度70之橡膠

規 格	L	L(總長)	L2(牙長)	D	底 盤
M16	104	105	50	55	ø60 ø80 ø110
	153	154	100	55	ø60 ø80 ø110

Material:

- Threaded spindle in nickel plated steel.

材質:

- 螺絲軸心全為鍍鋅及白鐵材質,底盤和螺絲軸心亦同.

規 格	L(總長)	L2(牙長)
M16	160/195	145.180

※以上其他尺寸必須訂做

■ 單迴路輪



■ MIT-RO534 Roller

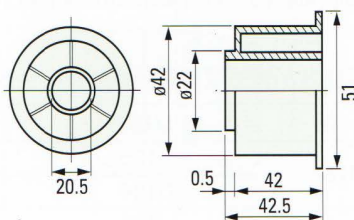

■ 雙迴路輪 (T迴路輪)



■ MIT-RO845 Roller

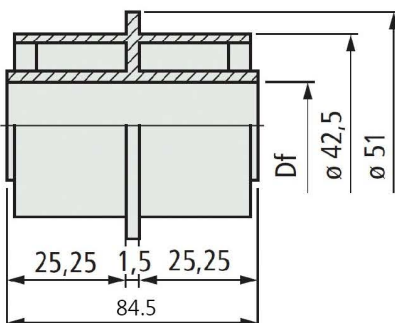

■ 長(平)迴路輪



■ MIT-RO634 Roller

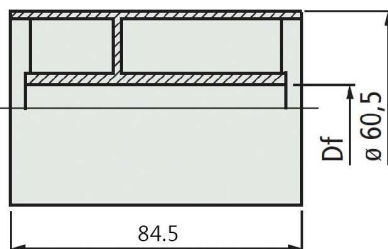

■ 固定配件頭



■ K-150

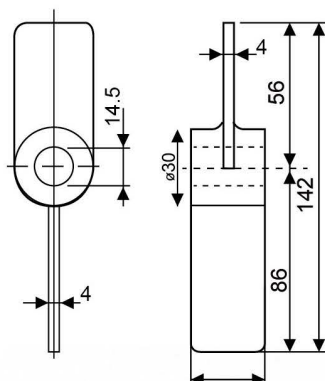

Part. No. 編號	Product name 產品名稱	Df(mm) 軸心直徑
RO534	Roller單迴路輪	16.5
RO534B	Roller單迴路輪	20.5

Material:

- Roller in nylon.

材質:

- 迴路輪為尼龍材質
- 數量：1組2只

Part. No. 編號	Product name 產品名稱	Df(mm) 軸心直徑
RO845	Roller雙迴路輪	16.5
RO845B	Roller雙迴路輪	20.5

Material:

- Roller in nylon.

材質:

- 迴路輪為尼龍材質

Part. No. 編號	Product name 產品名稱	Df(mm) 軸心直徑
RO634	Roller長(平)迴路輪	16.5
RO634B	Roller長(平)迴路輪	20.5

Material:

- Roller in nylon.

材質:

- 迴路輪為尼龍材質

Part. No. 編號	Product name 產品名稱
K-150	固定配件頭

Material:

- Nylon.

材質:

- 尼龍

DOOR HINGE 門樞紐

■ 小門樞紐



■ MIT-337-67023 Door Hinge

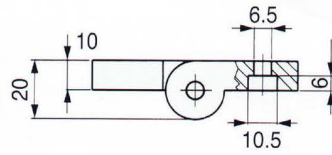
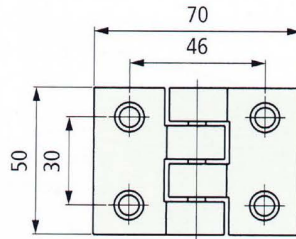

Material:

• Nylon.

材質：

• 尼龍

■ 大門樞紐



■ MIT-260-65021 Door Hinge

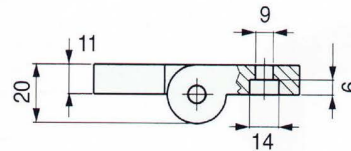
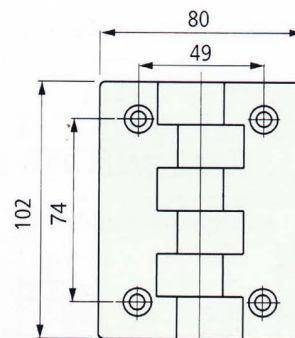

Material:

• Nylon.

材質：

• 尼龍

■ 軸套



• With sprockets

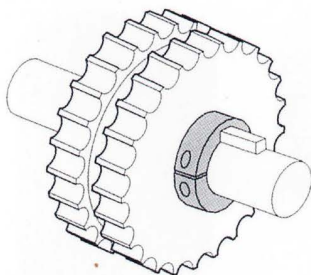

■ Shaft Collars

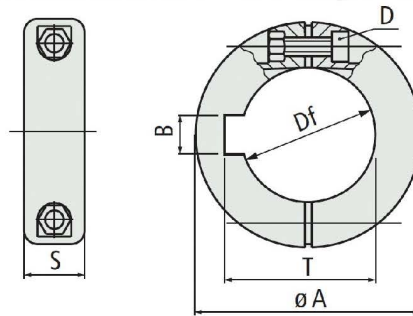

• With idler wheels

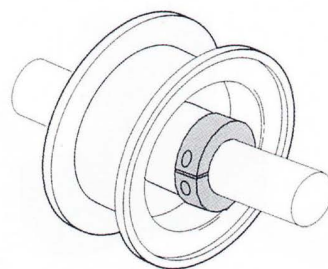

規格	S	F	øA	
ø20	14.5	42	20	M4
ø25	14	45	25	M4
ø30	16	49	30	M4
ø35	18	67	35	M5
■ 38.1	18	67	40	M5
ø40	18	67	40	M5

Material:

• Nylon.

材質：

• 尼龍

• With rollers

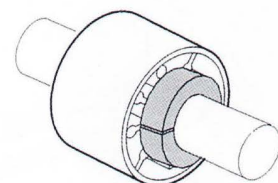

■ 萬向把手



■ Adjustable hand levers

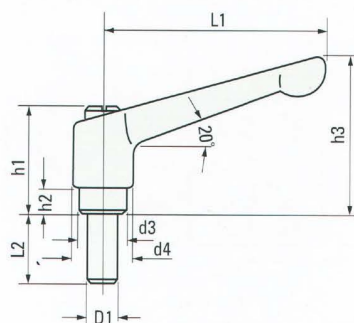

	L1	D1	*L2	d3	d4	h1	h2	h3
Small	45	M6	30	10	13	24.5	5	35
Medium	65	M8	30	13	18	31	7.5	46
Big	98	M10	30	19	24	43	10	65

* Length L2 can be shorter or made by ordering.

Handle: Zinc die coating

Internal parts: Stainless steel

* L2長度可做更改

■ 小把手—無鐵14123 / 有鐵14126



■ Handles-small

14123 (non-metal) 14126 (metal)

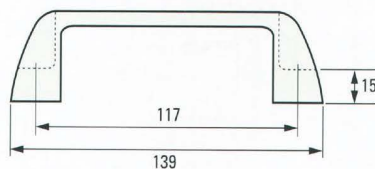

	I	L	C	H	D	d	M
14123	117	139	26	44	13	8.5	-
14126	117	139	26	44	-	-	M8

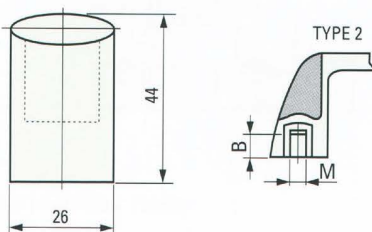

■ 大把手 14118



■ Handles-big

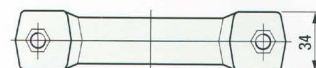
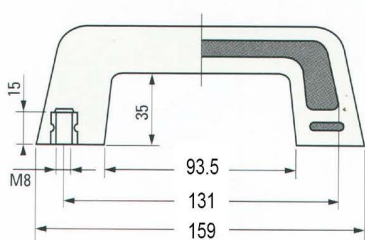

■ 噴水頭銅/白鐵 60° 120° TYPE B1-2 NOZZLE



■ 白鐵固定架 L: 115



■ MIT-L115 S/S

Material: • S/S AISI 304

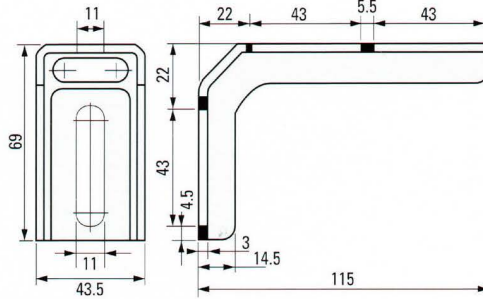

■ 白鐵固定架 L: 84



■ MIT-L84.5 S/S

Material: • S/S AISI 304

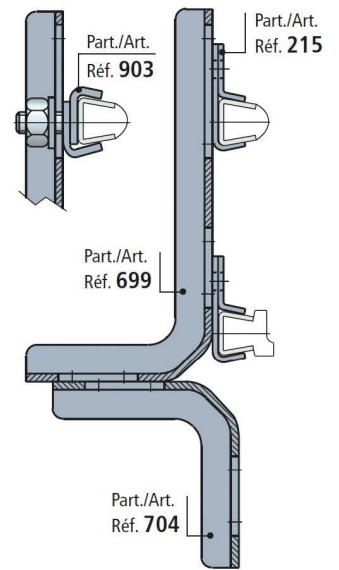
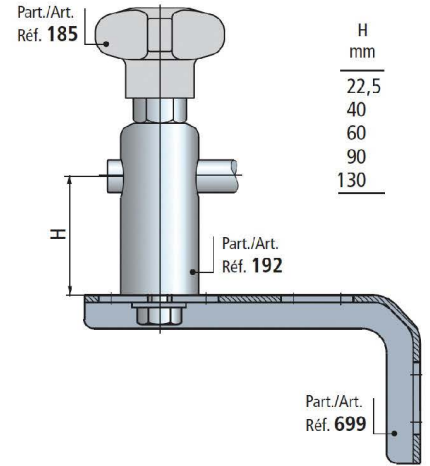
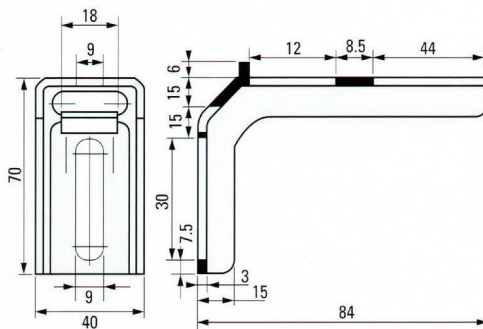

■ 護欄擋塊 GUIDE RAIL

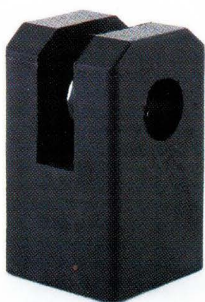

■ T型護欄擋塊 T-GUIDE RAIL



■ 福來輪 RETURN ROLLER
48 x 15 x 8.2



Mat Top Chain 網帶



← STW-381-POM-平面

STW-381-PP-平面 →

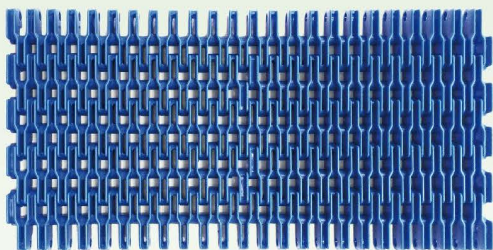
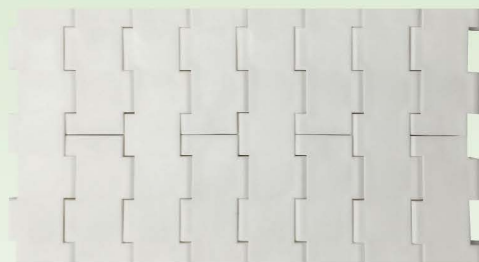

← SNB-RIB

STW-381-PP-方孔(灰) →

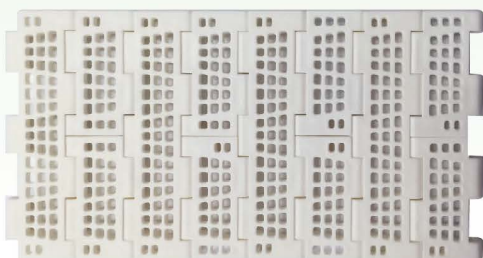
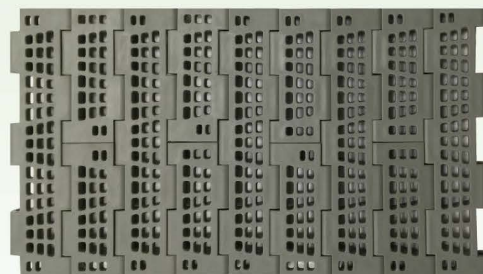

← STW-381-PP-方孔

STW-381-PP-圓孔 →

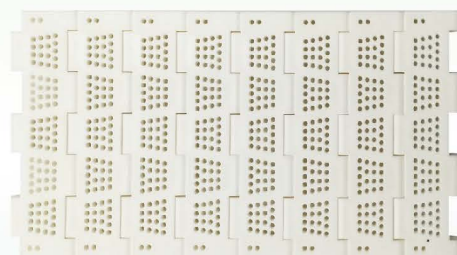

STW-381-PP+檔板H=50



STW-381-PP+內縮檔板

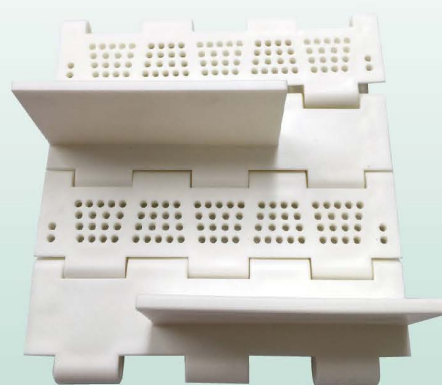

STW-381-各式檔板

Sprocket / Idler 齒輪/惰輪



MIT-RH8T
方孔齒輪



MIT - RH10T
齒輪



MIT - RH11T
齒輪



SNB-RIB-COMB梳子板



SNB-RIN-19T
方孔齒輪



SNB-RIN-19T25R
圓孔齒輪



台製惰輪



MIT-SWH齒輪



MIT-HDF11T齒輪



SHIUN TAI
ENTERPRISE CO., LTD

迅泰企業股份有限公司

SHIUN TAI ENTERPRISE CO., LTD

- TEL:+886-3-222-5666 • FAX:+886-3-222-5662
- www.shiuntai.com.tw • sales@shiuntai.com.tw
- 33852 桃園市蘆竹區南山路二段87號
No.87, Sec. 2, Nanshan Rd., Luzhu Dist., Taoyuan City 33852, Taiwan

